

HISTORIC DISTRICTS AND SITES OF THE CITY OF MIAMI BEACH • FLORIDA •

INCORPORATED 1915
DATE OF LAST REVISION JULY 24, 2024

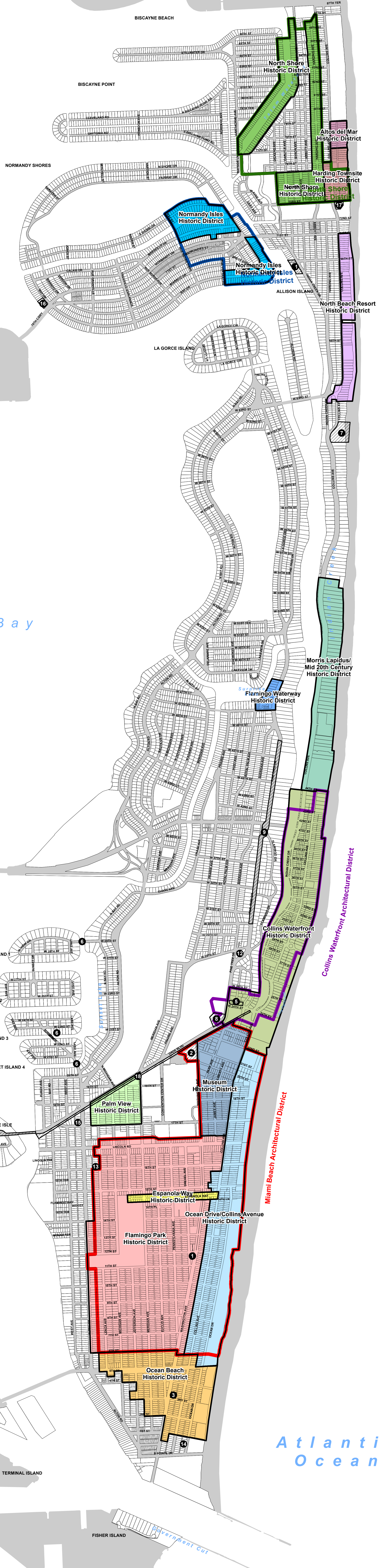
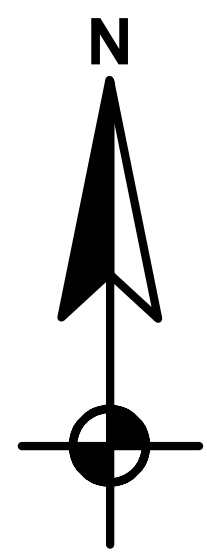

Biscayne Bay

Atlantic Ocean

MIAMI BEACH
PLANNING DEPARTMENT
1700 CONVENTION CENTER DRIVE
MIAMI BEACH, FLORIDA 33139
P 305.673.7550 F 305.673.7559

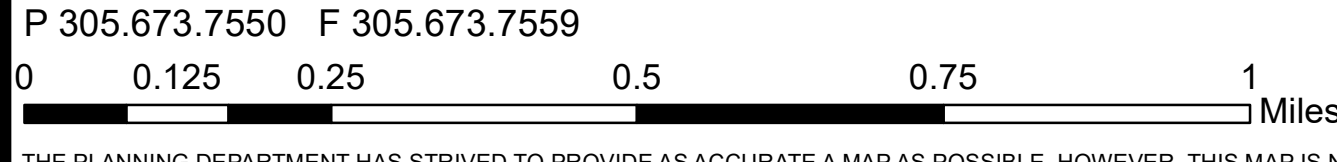

THE PLANNING DEPARTMENT HAS STRIVED TO PROVIDE AS ACCURATE A MAP AS POSSIBLE. HOWEVER, THIS MAP IS NOT TO BE CONSTRUED AS A SURVEY INSTRUMENT. THE CITY OF MIAMI BEACH MAKES NO REPRESENTATIONS OR WARRANTIES, NOR ASSUMES ANY LIABILITY ARISING FROM THE USE OF THIS MAP. FOR AN OFFICIAL DETERMINATION, PLEASE CONTACT THE PLANNING DEPARTMENT.

LOCAL HISTORIC DISTRICTS

- Espanola Way Historic District
- Altos del Mar Historic District
- Flamingo Park Historic District
- Ocean Drive/Collins Avenue Historic District
- Museum Historic District
- Ocean Beach Historic District
- Harding Townsite Historic District
- Palm View Historic District
- Collins Waterfront Historic District
- North Beach Resort Historic District
- Flamingo Waterway Historic District
- Morris Lapidus/Mid 20th Century Historic District
- Collins Waterfront Architectural District
- Normandy Isles Historic District

NATIONAL REGISTER HISTORIC DISTRICTS

- Miami Beach Architectural District
- Normandy Isles Historic District
- North Shore Historic District
- Collins Waterfront Architectural District

LOCAL HISTORIC SITES

- 1 Old City Hall Historic Site

- 2 21st St Recreation Center Historic Site
- 3 Congregation Beth Jacob Historic Site
- 4 Venetian Causeway Historic Site
- 5 Miami Beach Woman's Club Historic Site
- 6 Sunset Island Bridges Historic Structures
- 7 The Bath Club Historic Site
- 8 Dade Blvd Fire Station Historic Site
- 9 Pine Tree Dr Historic Roadway
- 10 Flagler Memorial and Monument Island Historic Site
- 11 69th St Fire Station Historic Site
- 12 28th St Obelisk and Pumping Station Historic Structure
- 13 1600 Lenox Ave Historic Site
- 14 36 Ocean Dr Historic Site
- 15 1700 Alton Rd Historic Site
- 16 International Inn Historic Site
- 17 North Beach Bandshell Historic Site
- 18 Collins Canal Historic Structure